

## METHOD OF INSTALLATION

### Wall Mounted

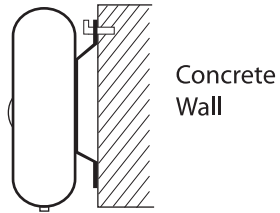

### Ceiling Mounted

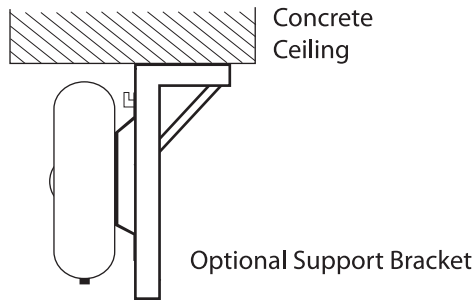

### Floor Standing

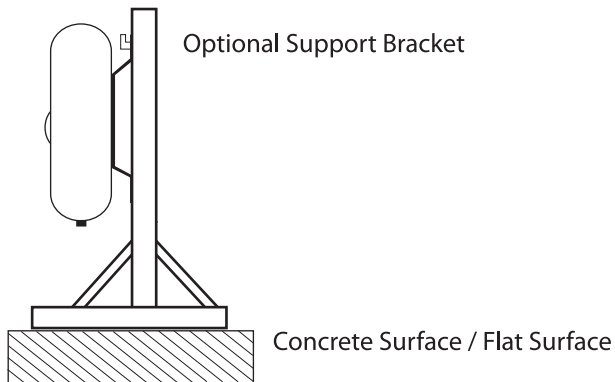

**\* Remarks:**  
If heater tank not installed according to shown methods warranty is considered void.

# SEERS

## STORAGE HEATER

**CH-40L**

**CH-60L**

**CH-80L**

**CH-100L**



**OPERATION MANUAL BOOK**

**IMPORTANT:**  
PLEASE READ THESE INSTRUCTIONS  
BEFORE USE AND RETAIN FOR  
FUTURE REFERENCE

# OPERATION MANUAL BOOK

## CONTENTS

NOTE.....	2
ELECTRICAL INSTRUCTION.....	2
WARNING .....	2
PRODUCT FEATURES .....	3
SECURITY CHARACTERISTICS .....	3-4
PRODUCT SPECIFICATION - HORIZONTAL .....	5
PRODUCT STRUCTURE .....	6
ASSEMBLING INSTRUCTION .....	6
PIPE CONNECTIONS .....	7
CAUTION ITEMS .....	7
OPERATION INSTRUCTION .....	8
DAILY AND COMMON MAINTENANCES.....	9
ELECTRICAL DIAGRAM.....	10
TROUBLESHOOTING.....	10

## NOTE

1. Read instructions before installation.
2. Water heater should not be operated without a pressure relief valve.
3. Valve & valve relief pipe shall not be sealed or blocked.
4. Appliance shall be filled with water before switching on.
5. Discharge pipe connected to the pressure relief device to be installed in a continuously downward direction & in a frost free environment.
6. The pressure relief device is to be operated regularly to remove lime deposits and to verify that it is not blocked.

## TROUBLESHOOTING

Symptoms	Causes	Remedy
Indicator Light Fail or System Not Operating	1. No Supply Or Bad Contact Point.	Inspect for proper Supply as Label.
	2. Internal Fault.	Contact Service Counter.
	3. Faulty Indicator.	
	4. Overheat Protection Activated.	
Low Water Temperature or No Hot Water	1. Insufficient Heating Time.	Wait of completion of heating process.
	2. Low Setting Temperature.	Adjust Setting.
	3. Temperature Controller Faulty.	Contact Service Counter.
	4. Heat Module faulty.	
Water Leakage	1. Pipe Fittings.	Contact service Counter.
	2. Storage Tank.	

Remark : Drawings are subject to change without prior notice .

## MAINTENANCES

- Frequent checking on the connection of power sources and the outlet is in good condition.
- Device must be earthed, inclusive of all metal piping connected to the heater.
- Regularly trigger the pressure relief valve.

## ELECTRICAL DIAGRAM

Electric Wiring Diagram (CH-40L & CH60L)

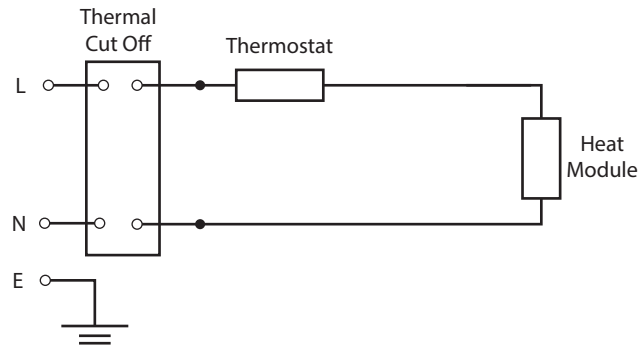

Electric Wiring Diagram (CH-80L & CH100L)

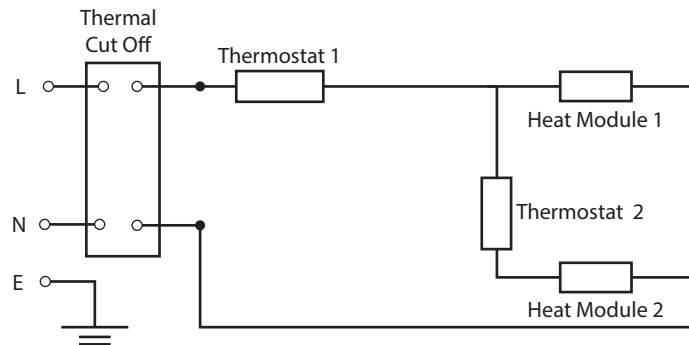

## ELECTRICAL INSTRUCTION

The heater must be permanently connected to the electricity supply through a double pole linked switch having a contact separation of at least 3mm in all poles incorporated in the circuit and out of reach from the person using the shower.

1. The use of plug and socket is not recommended
2. The appliance must be earthed
3. All wiring must confirm to local requirements. The Installation must be done by qualify electrician.

## WARNING

1. Warranty will be void due to system mishandling and improper installation.
2. Read instruction manual before installation.
3. Connect power supply source according to rated voltage value.
4. Remove power durina cleaning process.

### CAUTION

1. Fill heater tank with water before operation.
2. Do not operate during water interruption.
3. Do not block pressure relief valve outlet. Drainage pipe should be well ventilated.
4. Always connect heater ground wire to earthing source.
5. Pressure relief valve shall be fitted in the installation.
6. Water storage heater shall not be operated without a pressure relief valve.

This appliance is not intended for use by persons (including children) with reduced physical, sensory or mental capabilities, or lack of experience and knowledge, unless they have been given supervision or instruction concerning use of the appliance by a person responsible for their safety.

Children should be supervised to ensure that they do not play with the appliance.

## PRODUCT FEATURES

This heater is fixed with a manual reset over temperature protection circuitry. Reset button is located beneath the right end cover. To avoid shock hazard, disconnect power source before open the cover.

## SECURITY CHARACTERISTICS

1. **Pressure relief valve:** This electrical water heater fits with mono-directional pressure relief valve. It must be installed at the cold water inlet sector of this unit of the electrical water heater. The pressure-relief valve prevents excessive pressure built – up in the storage tank and must not be removed or replaced. In the event the pressure in the storage tank exceeds 0.75 MPa, the drain valve will be triggered operate and vent the water through the overflow pipe which must not be closed or blocked. Excessive pressure or steam will be drained out thru pipe connected (Diagram 1). The pressure discharge lever makes it easy to discharge water from the storage tank when changing the heating source or remove any blockage at the drain valve.

The water may drip from the discharge pipe of the pressure-relief device and that this pipe must be left open to the atmosphere;

The pressure-relief device is to be operated regularly to remove lime deposits and to verify that it is not blocked.

Incorporated RCD in the installation circuit of storage water heater.

**Note:** For the interior-ventilating styled security valve, its pressure Leakage exit sector may not exits the water drops to drip down. Otherwise, during the heating procedure, the water-entering pipe's outer cover under the safety valve may have a certain temperature. This belongs to the normal conditions. This indicates that it is internally-draining the leakage pressure.

2. If need to make the tank empty, first close the water-entering valve, open the water-exiting valve. Then remove security valve with tools. Lift up the handle; let the water in the tank naturally flow out. (Diagram 2)

3. **How our water heater can be drained.**

Turn off main supply. Close incoming water valve and open hot water outlet valve (at mixer tap) Then loosen and unplug drain cap, connect a rubber hose to drain fitting and release water out of the tank. Once the water stop flowing out, open incoming valve. This will flush out any remaining sediment left inside the heater. Fix the drain cap until tighten after water run clear from the end of drain outlet. Filled up storage tank until water flow out from hot water outlet (mixer tap). Turn on the power-supply, and test the pressure relief valve accordingly to the manufacturer instruction. This safety device is designed to prevent excess pressure build-up or overheating inside the tank. If it's faulty, kindly contact directly our service centre.

## OPERATION INSTRUCTION

- **Water filling process :-** After fixing hot and cold water pipe connection, open the water inlet valve and hot water outlet valve (mixer tape), wait till water flow out from mixer tap (hot side), close mixer tape and checked for possible leaks along all piping connection. Cold water inlet valve to remain opened at all time
- **Turn on the power:** After confirming the tank to be fully filled up, turn on the power source. The heating indicator will light up.
- **Hot water operations :** the water heater achieve hot water at sufficient time. It is compulsory to fix hot water supply to a mixer set for normal usage. User is to adjust hot & cold mixer to own comfort.  
**Cautions:** for water temperature regulating at water heater tank, turn control knob clockwise for maximum temp setting and turn control knob anti-clockwise for minimum temperature setting.
- **Overheating protection:** Heating process stopped and manually reset by pressing the button on thermal cut off the power
- **Automatic temperature control:** When water temperature reaches the set value, it will automatically cut off the power and half heating. Meanwhile, the heating indicator will be off. The electrical water heater will be in temperature-maintaining condition. When the water temperature in the tank drops a certain degrees, it will automatically turn on heating. After reaching the set temperatures, it will automatically cut off the power and be in the temperature-maintaining condition. The warm indicator will light up.

### References for storage tank size comparison

Modal	Capacity	Heating time for cold water from 30°C to 60°C and total power consumption per heat cycle	
		Seers (0.66-1.2kw)	Conventional (3kw)
CH-40L	40L (8.8 imp gal)	70min-0.77kwh	28min-1.4kwh
CH-60L	60L (13.3 imp gal)	90min-0.99kwh	42min-2.1kwh
CH-80L	80L (7.7 imp gal)	60min-1.2kwh	60min-3kwh
CH-100L	100L (22.2 imp gal)	70min-1.4kwh	70min-3.5kwh

## PIPE CONNECTIONS

- All the pipe parts are G $\frac{1}{2}$ ". Wind a certain raw material tape at the water inlet thread sector of the electrical water heater (Blue Sign Identification) Then re-install the mono- directional security valve well.
- The remaining pipe's connection method can be referred to Diagram 8

## CAUTION ITEMS

- The installed walls must be solid; wall mounted bolt must be tightened to secure the wall mounted tank.

**Diagram 8**

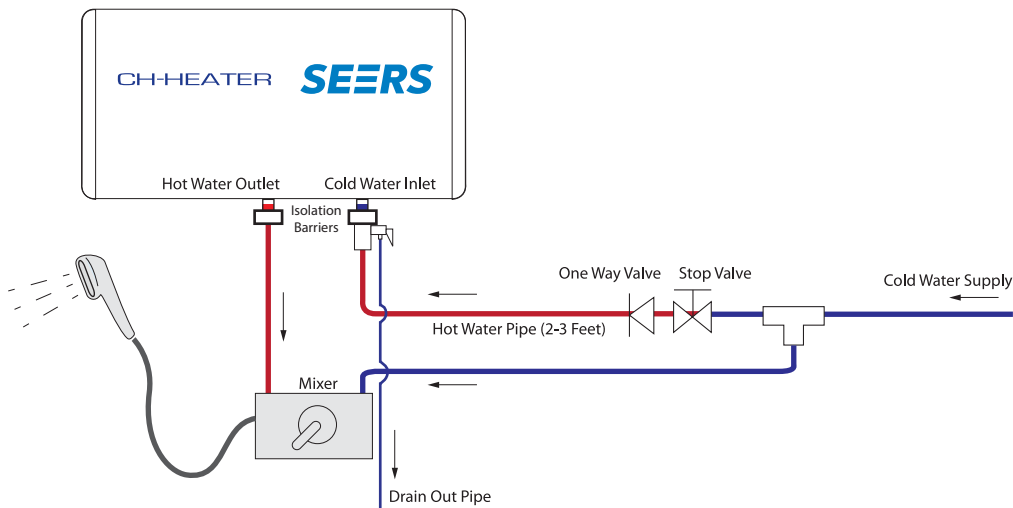

### 4. For pressure relief valve instruction:-

- Remove the valve from the packing (diagram 3)
- Ensure the black o-ring attached (diagram 4)
- Fix the valve follow the direction until tighten (diagram 5)
- Affix the income water pipe with (diagram 6)

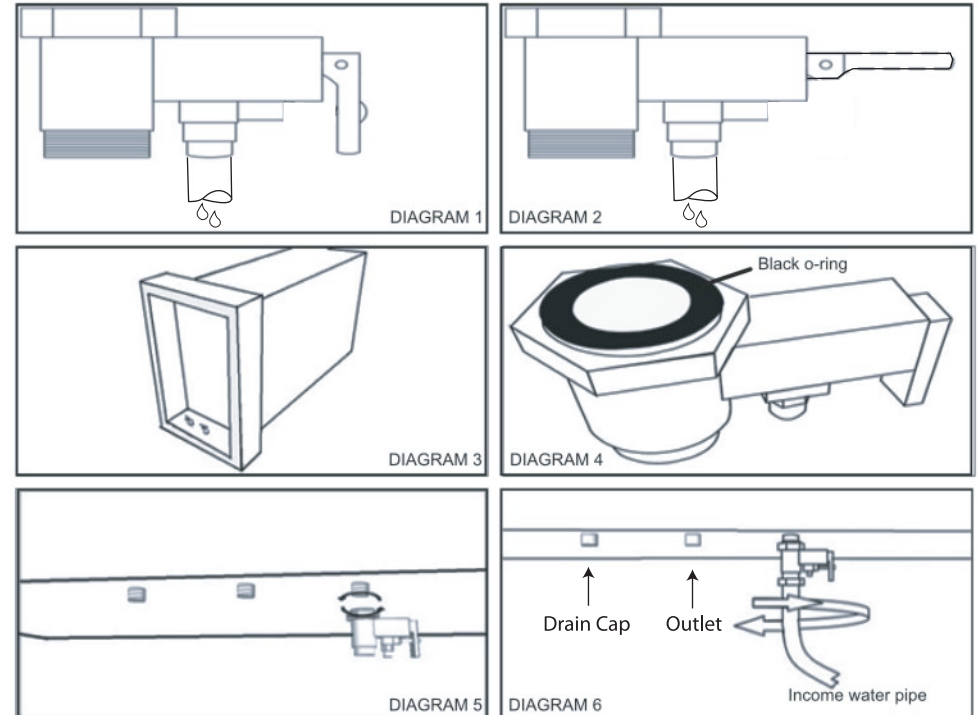

4. If the supply cord is damaged, it must be replaced by the manufacturer, its service agent or similarly qualified person in order to avoid a hazard.
5. Special screw applied on end cover, only authorized personal is allowed to access.

## PRODUCT SPECIFICATION - HORIZONTAL

Model/ Specification	CH-40L	CH-60L	CH-80L	CH-100L
Capacity (L)	40	60	80	100
Rated Voltage Input	240Va.c	240Va.c	240Va.c	240Va.c
Rated Power (Watt)	660	660	1200	1200
Rated Frequency (Hz)	50	50	50	50
Rated Max Temperature ( C )	60	60	60	60
Min Rated Pressure (Pascals)	100,000	100,000	100,000	100,000
Max Rated Pressure (Pascals)	650,000	650,000	650,000	650,000
IP Code	IP21	IP21	IP21	IP21
Fixing Mode	Hanging Type	Hanging Type	Hanging Type	Hanging Type
Net Weight (Kg)	12.5	16	20.2	23.8
Gross Weight (kg)	15	18.5	23.2	26.8
Product Side (mm)	726(L) 435(H) 262(W)	798(L) 497(H) 297(W)	1023(L) 497(H) 297(W)	1243(L) 497(H) 297(W)
Carton Side (mm)	780(L) 510(H) 315(W)	855(L) 555(H) 350(W)	1070(L) 555(H) 350(W)	1285(L) 555(H) 350(W)
Water Inlet & Outlet	Dia-1/2"	Dia-1/2"	Dia-1/2"	Dia-1/2"
Installation	Horizontal Wall Mounted	Horizontal Wall Mounted	Horizontal Wall Mounted	Horizontal Wall Mounted

## PRODUCT STRUCTURE



## ASSEMBLING INSTRUCTION

This electrical water heater should be mounted on solid cement walls. Furthermore, the places where are close to the power source sockets and supply source. (Diagram 7)

**Caution:** Please try to use our company's fitted accessories to mount this electrical water heater. After confirming the brackets to be firmly fixed for the reliabilities, then you can hang on this electrical water heater may full down from the walls, and cause the severe damaging accidents.

1. Before determining the bolt hole's position, you should guarantee the right side of the electrical water heater to be more than 200mm away the ground. This will be convenient to leave out a certain space to maintain when it is necessary.

2. Assembling Method : After selecting the proper positions well, use the fitted inflation bolts to fix the hanging board firmly, and then hang on the electrical water heater

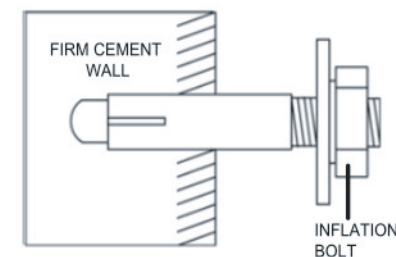

Diagram 7